

KEY:

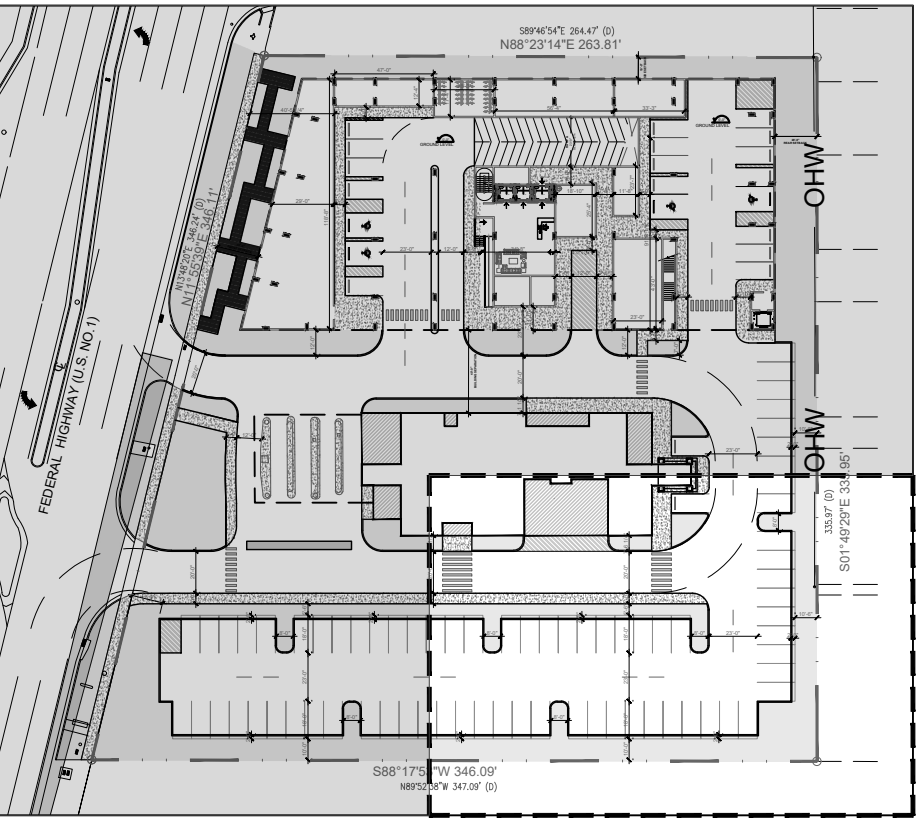

absolute-idea.com
CANAL PARK
3323 NE 163rd Street, Suite 200 North Miami Beach, FL 33160
305.792.0015 305.931.0279 info@absolute-idea.com

SEAL
KEN GARDNER
FLA 1569
TO THE BEST OF MY KNOWLEDGE, THE PLANS AND SPECIFICATIONS COMPLY WITH THE MINIMUM REQUIREMENTS FOR THE PROFESSIONAL SEAL AND CERTIFICATION AS DETERMINED BY THE BOARD OF PROFESSIONAL ENGINEERS AND ARCHITECTS.



REV.	DATE	DESCRIPTION
01	XX-XX-2024	D.R.C. SUBMITTAL

ALL MEASUREMENTS MUST BE VERIFIED BEFORE BEGINNING THE WORKS. NO MEASUREMENTS ARE TO BE SCALED DIRECTLY FROM THIS DRAWING.

Key section
PROGRESS SET

Client
VERA FUND
NICK POLYUSHKIN
& YURI KHARITONENKOV
TEL: 305.833.3303

Project
**1600 S FEDERAL HIGHWAY
(MIXED-USE PROJECT)**
1600 SOUTH FEDERAL HIGHWAY,
POMPANO BEACH, FL 33062

Title PLANTING PLAN GROUND FLOOR	
Drawn GSLA	Field LANDSCAPE ARCH
Verified KG	Scale as shown
Approved KG	Date 10-09-2024
Project Manager KG	Dwg. no. L-204
Project PZ24-12004-338	

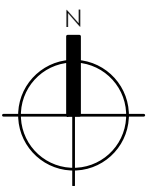

PLANTING PLAN - GROUND FLOOR

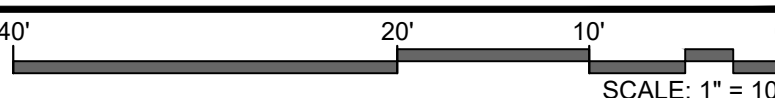

DRC
10/09/2024
PZ24-12004-338

03/05/2025